

TELEX

RADIO DISPATCH PRODUCTS

IP-1616/C-6200 Handset Option (Field Installation)

The **IP-1616/C-6200 Handset Option** allows the user to install a handset to the C-6200.

IP-1616/C-6200 Case Top

Observe the right side of the **IP-1616/C-6200 case top** to determine if there are handset mounting holes. Three black rubber plugs fill the handset mounting holes. Older units require mounting holes to be drilled. For more information, see “IP-1616/C-6200 Drilling Instructions” if holes are required.

To **remove the unit’s case top**, do the following:

1. Remove the **screws** attaching the top case to the unit.
2. With the unit’s left side facing forward, remove the **top** and place it to the right (back) of the unit.
3. Remove the **rubber plugs** from the case top. See Figure 1.

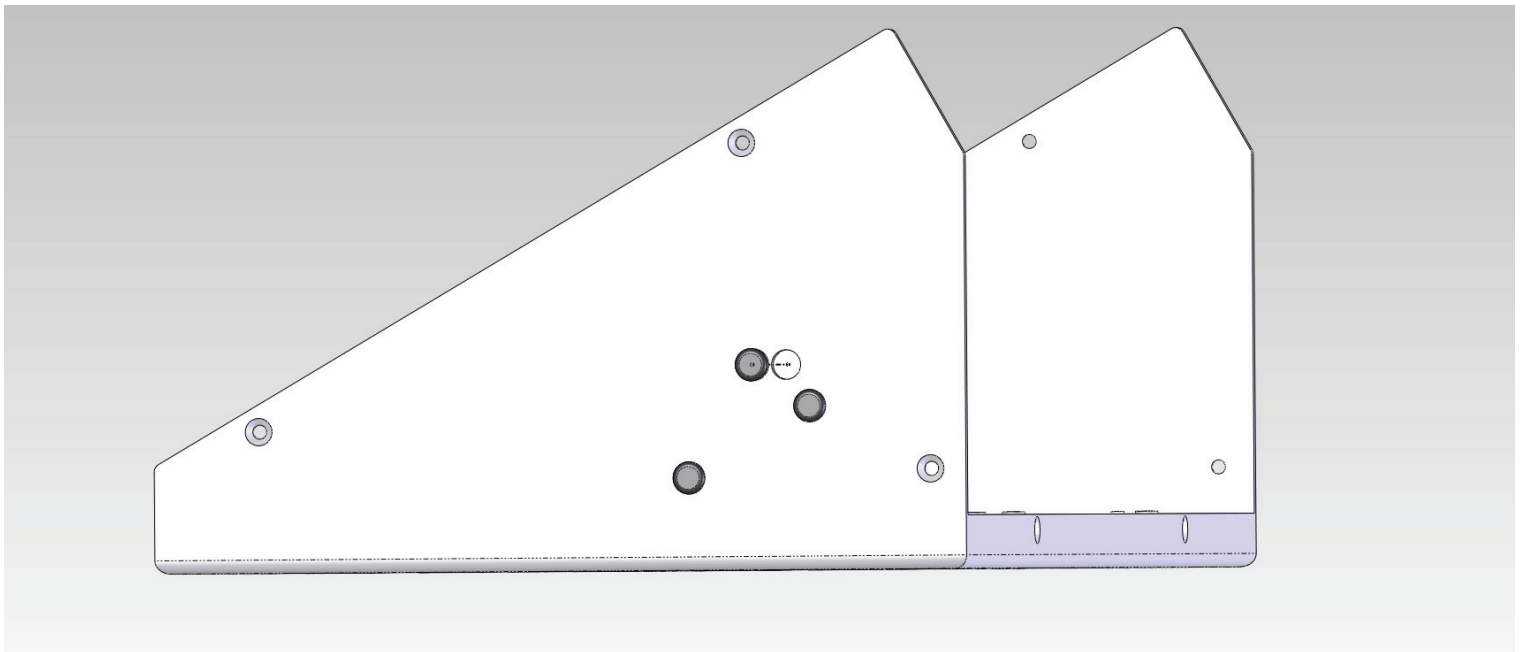

FIGURE 1. IP-1616/C-6200 Case Top with Rubber Plugs

TELEX

RADIO DISPATCH PRODUCTS

4. Lay out the **Option Kit** parts and compare with the **assembly list** to determine if all of the parts are present. See Figure 2.

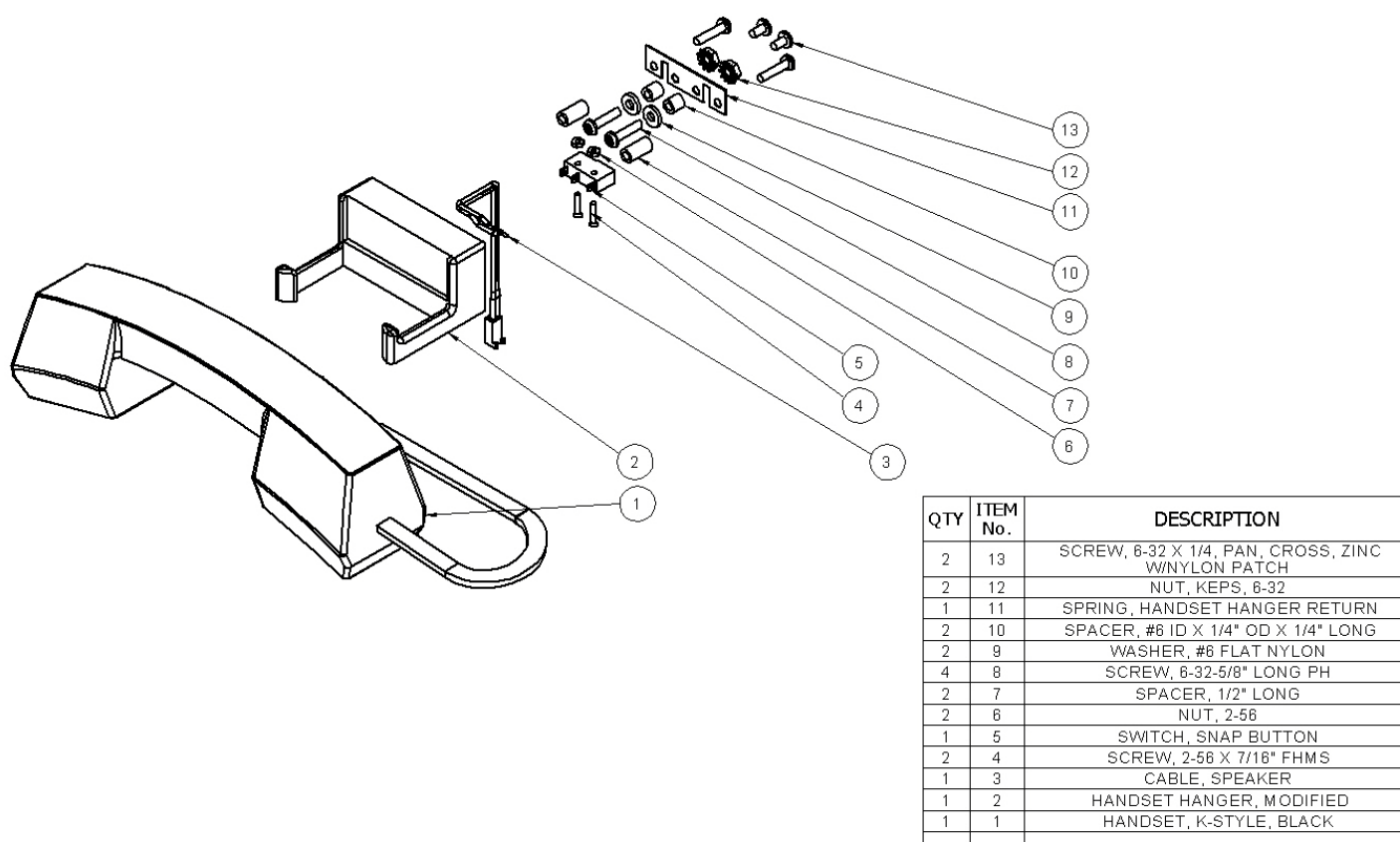

FIGURE 2. Option Kit Parts

NOTE: When drilling holes, items 9, 10, and 12 are used to mount the Hanger Return Spring. (Item 13 is not used.)
The Washer and Spacer both go on the inside of the case. If installing in a case with predrilled holes, items 9, 10, and 12 are not required.

TELEX

RADIO DISPATCH PRODUCTS

5. Insert the **cable** through the hole of the case top so the connector is on the inside of the case. See Figure 3.

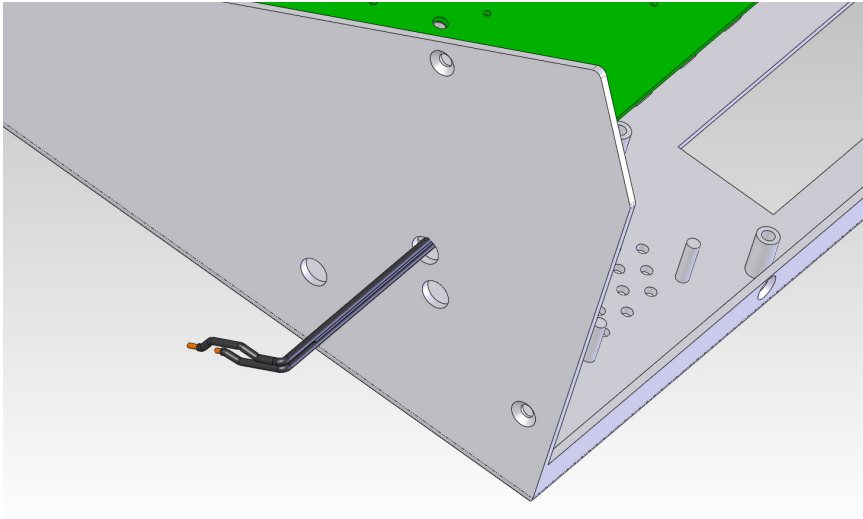

FIGURE 3. Inserting Cable through Case Top

6. Solder one **lead** to **pin #1** .
7. Solder the **other lead** to **pin #3** . See Figure 4.

NOTE: Pin numbers are on the side of the switch.

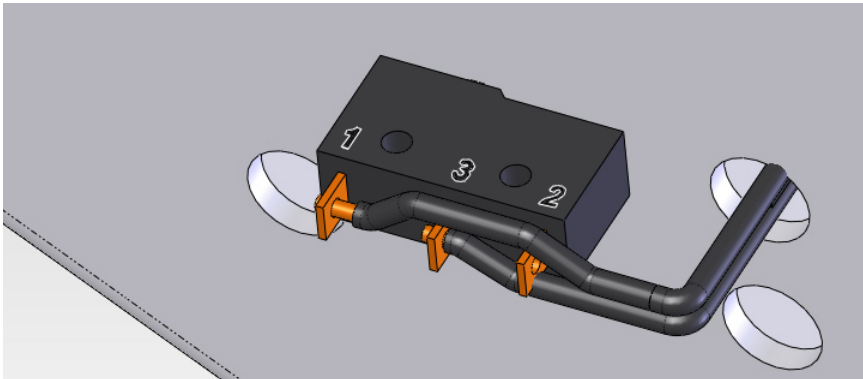

FIGURE 4. Lead Placement

TELEX

RADIO DISPATCH PRODUCTS

8. Assemble the **Snap Switch** to the handset hanger using the 2-56 x 7/16" long screws and nuts so the switch button faces out. See Figure 5.

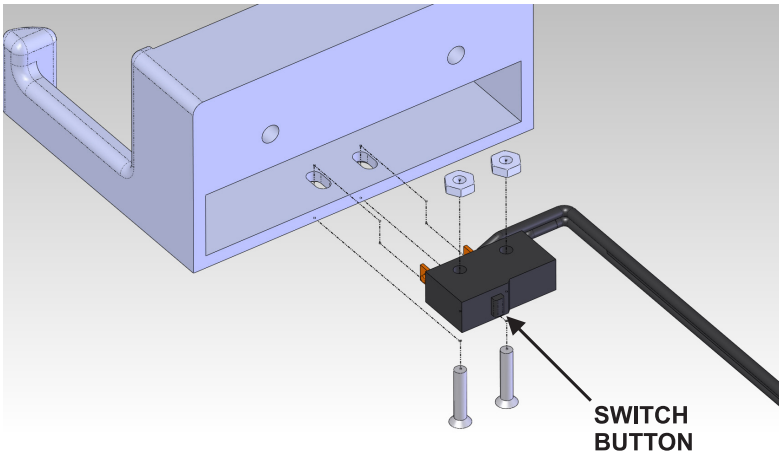

FIGURE 5. Assembling Snap Switch to Handset Hanger

9. After assembling the switch to the hanger, super glue the **nuts** to the switch housing.

NOTE: Take care not to get glue on the screw threads. This allows the switch placement to be adjusted after it is assembled on the case side. After the glue dries, verify the screws can be loosened and tightened without the nuts moving before proceeding. The speaker may have to be removed to install the hanger return spring.

10. Inside the case top, assemble the **Hanger Return Spring** to the standoffs using the 1/4" long screws. *The spring must be installed so the open slots face away from the keypads and toward the bottom edge of the case top. See Figure 6.*

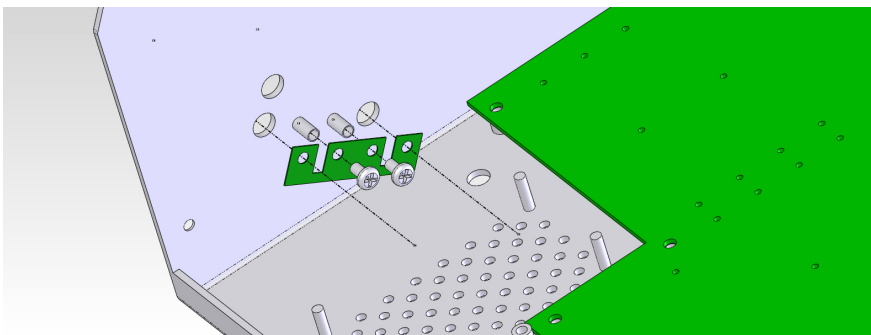

FIGURE 6. Hanger Return Spring

TELEX

RADIO DISPATCH PRODUCTS

To assemble the **Hanger Return Spring**, do the following:

1. Place the **long standoffs** through the holes in the case top and against the spring.
2. Push the **screws** through the spring holes and through the standoff.
3. Secure the **hanger** to the standoff with the 5/8" long screws. See Figure 7.

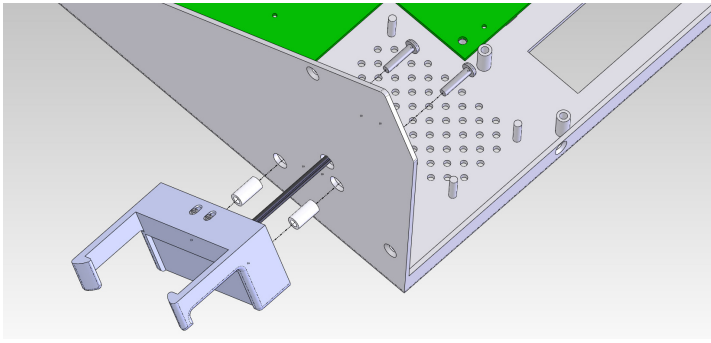
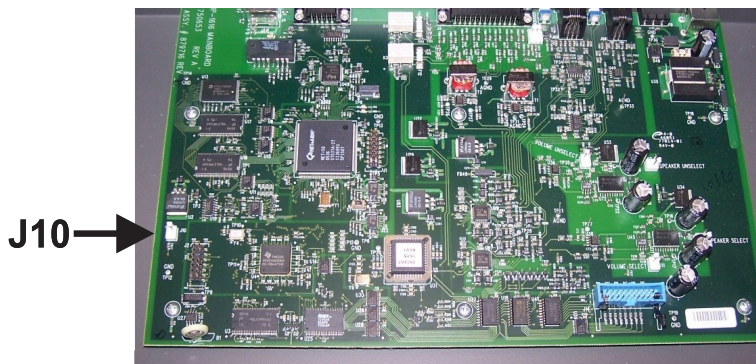
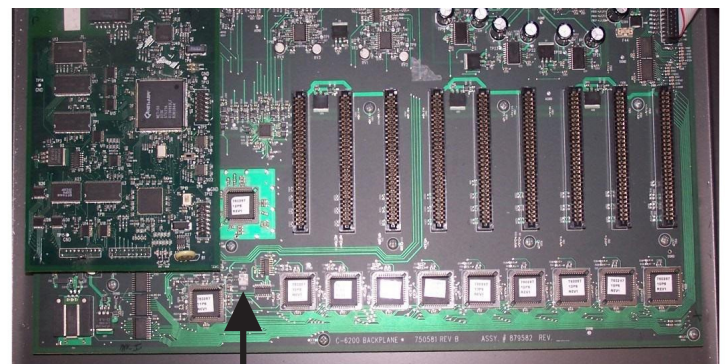

FIGURE 7. Securing Hanger to the Standoff

4. Plug the **switch cable connector** into the PCBA.
On the IP-1616, connect to **J10**.
On the C6200, connect to **J80**. See Figure 8.



IP-1616



J80

C6200

FIGURE 8. IP-1616 and C6200

NOTE: The cable may be short which may require partially placing the case top on the unit as the switch cable connector is plugged into the PCBA.

TELEX

RADIO DISPATCH PRODUCTS

5. Replace the **case top** on the unit.
6. Adjust the **hanger switch** so the button is off the surface of the case top without the handset.
When the handset is replaced the switch button should be active. This is done by loosening the mounting screws in the hanger and moving the switch in or out until you can hear the switch open and close as the handset moves on and off the hanger.
7. Place the **handset** on the hanger.
8. Plug the **handset** into the connector marked HANDSET on the back of the unit.

Handset Mounting Holes

Older IP-1616/C-6200 units require handset mounting holes to be drilled.

IP-1616/C-6200 Drilling Instructions

To **drill handset mounting holes into the IP-1616/C-6200 case top**, do the following:

1. Remove the **screws** holding the case top to the unit and position the case top to allow the right side of the case to be drilled.
2. Go to <http://www.telex.com/US/dispatch/downloads>, to download the drill template needed from the Drawings section.
3. Print the drill **template** and verify it is to scale.

NOTE: Before drilling, take measures to insure no drill chips and/or debris get into the electronics of the unit.

4. Overlay the **template** on the side of the unit and **punch center pins** for each hole to be drilled.
5. Drill the **holes**. (3X .313" Dia., 2X .144" Dia.)
6. Proceed with **Step 4** on page 2.